

Model W3R Receiver Kit
for use with W3 Wireless
Audio Adapter

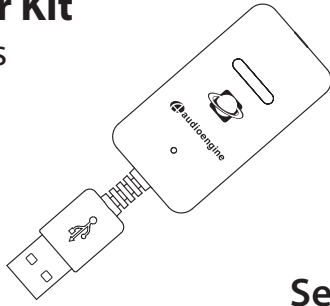

Setup Guide
V03

Safety Information

Information for Users on Disposal of Old Equipment



Attention:
This symbol is only valid in the European Union.

[European Union]

This symbol indicates that the electrical and electronic equipment should not be disposed as general household waste at its end-of-life. Instead, the product should be handed over to the applicable collection point for the recycling in accordance with your national legislation.

By disposing of this product correctly, you will help to conserve natural resources and will help prevent potential negative effects on the environment and human health that could otherwise be caused by inappropriate waste handling of this product. For more information about collection point and recycling of this product, please contact your local municipal office, your household waste disposal service or the shop where you purchased the product.

Penalties may be applicable for incorrect disposal of this waste, in accordance with national legislation.

[Other Countries outside the European Union]

If you wish to dispose of this product, please do so in accordance with applicable national legislation or other rules in your country for the treatment of old electrical and electronic equipment.

FCC

This device complies with Part 15 of the FCC Rules Operation that is subject to following two conditions:

- (1) This device may not cause harmful interference and,
- (2) This device must accept any interference received, including interference that may cause undesired operation.

Warning: Changes or modifications to this unit not expressly approved by the party responsible for compliance could void the user authority to operate the equipment.

Introduction

Welcome to the Audioengine family and congratulations on your purchase!

The Audioengine team is dedicated to bringing you the highest-quality listening experience possible and the W3 was designed with the same attention to detail and operational

simplicity as other Audioengine products. Our goal is to get you to your music as quickly as possible, without all the "gadget tinkering" that so many other products require. We wish to thank our customers, distributors, and resellers for helping us create another quality Audioengine product.

What's in the box

- (1) Wireless Audio Receiver
- (1) Power Adapter
- (1) RCA Adapter "Y" Cable
- (1) Mini-jack (3.5mm) Cable
- (1) Setup Guide

Features

- Add extra wireless zones to your W3 system
- Stream your music to up to 4 receivers
- Easy setup, connects in seconds
- Works with Mac/PC, or without a computer
- Plug-n-play, no software or network setup
- 100ft (30m) typical range with no delay, drop-outs, or interference
- Plays music from any media player
- CD-quality, 16-bit stereo sound with no added compression

Adding a Receiver - How to Pair

The following procedure explains how to add additional W3 Receivers to a W3 Sender (or to pair a Receiver to another Sender).

Up to four W3 Receivers may be paired with one Sender, allowing the Sender to simultaneously broadcast audio to all Receivers, with no degradation of the audio signal or range.

Pairing a Sender and Receiver:

- 1) Connect the W3 Receiver to be paired to the included power adapter and plug the adapter into a power outlet.
- 2) Connect one of the included audio cables from the W3 Receiver's audio output to an available input on your music system.
- 3) Go to the W3 Sender and press and release the pair button on the W3 Sender. The status indicator will blink rapidly.
- 4) Go to the W3 Receiver and press and release the pair button on the Receiver.
- 5) Both W3 Sender and Receiver status indicators will turn solid, indicating they are now paired.
- 6) Repeat these steps to add additional W3 Receivers.

Note: For best performance, keep at least 6" distance between Senders and Receivers. Once a Sender and Receiver are paired, they will remember each other.

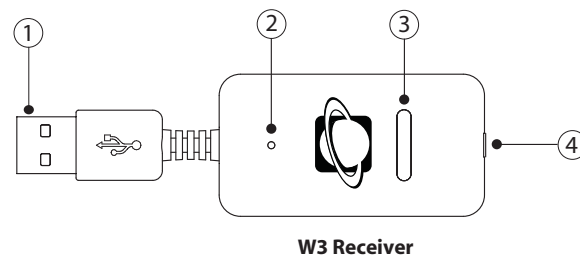

- ① Power connector
- ② Status indicator
- ③ Pair button
- ④ Audio output jack

More Information and Support

More product information and setup tips can be found here:
<http://audioengineusa.com/Store/Audioengine-W3>

If you have any questions or feel you may need service, contact us via email: support@audioengineusa.com

or call toll-free in the United States: (877) 853-4447